

No:

SB197-20

Date:

11/03/20

Issue:

2

Subject:

Tailgate Control Box Checks and Breather Modification

Olympus/OLTP Packer Control Station

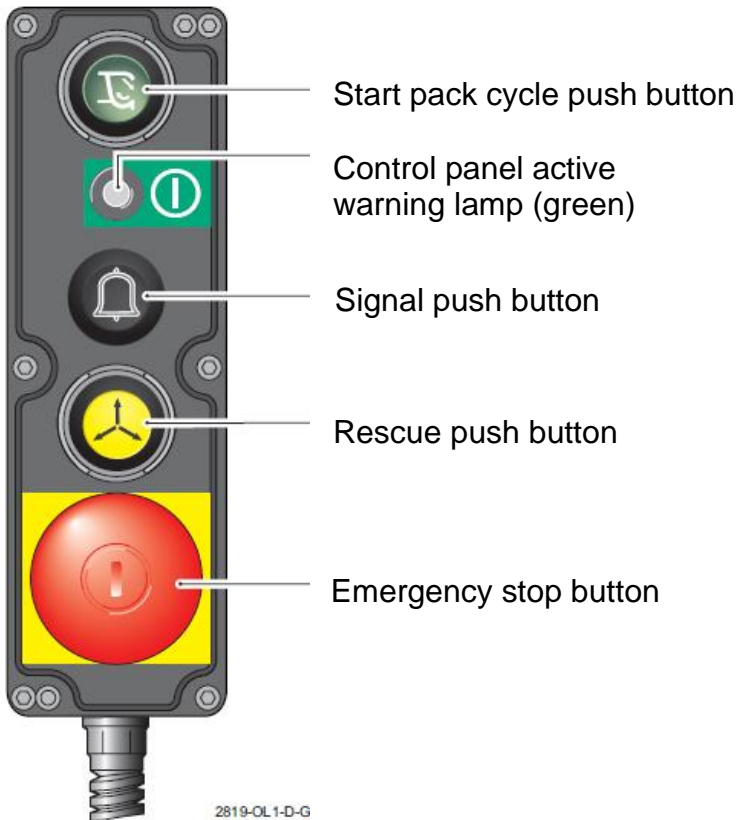

In cab monitor icons displayed when button pressed



Operation of all buttons should be checked daily by drivers as well as during vehicle inspections, the control panel active LED should illuminate when the relevant control station is active.

- Start pack cycle push button, this should start the packing mechanism when the selected control box is illuminated, all emergency stops are released, the body on/off switch is in the on position and has been reset, the truck has the PTO selected (if applicable) and the gearbox is in neutral.
- The signal push button operates an in-cab audible warning buzzer.

No:

SB197-20

Date:

11/03/20

Issue:

2

Subject: Tailgate Control Box Checks and Breather Modification

- The rescue push button when pressed will unfold the packer plate and take the carriage plate up to the top whilst you hold your finger on the button, the rescue button can be operated from either side control station with the packer moving, stationary or with an emergency stop button pressed, at the same time it will show the yellow icon on the in cab monitor, all three conditions should be tested, as soon as the rescue button is released the mechanism will stop. To return to normal operation the system will need to be reset by turning the body on/off switch off and on again.
- The emergency stop buttons should stop the packing mechanism, bin lift (if applicable) and pod (if applicable) immediately when pressed, show the icon on the in cab monitor and sound a bleeper in the cab, it is important to check the operation of the buttons with the packer operating. To return to normal operation the system will need to be reset by turning the body on/off switch off and on again.

Olympus/OLTP manual override control station

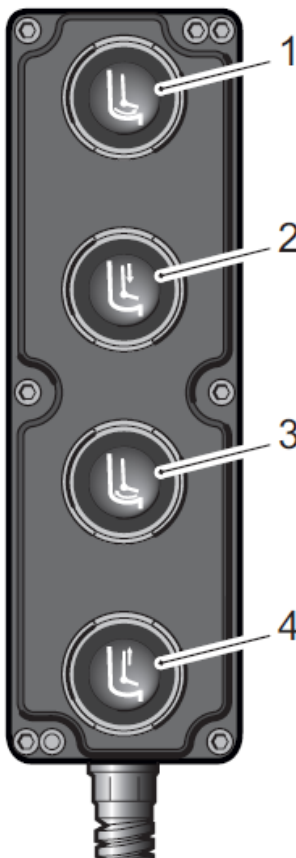

1. Unpack button, opens the packer plate
 2. Carriage plate down button, moves the carriage plate down the slide track
 3. Pack button, closes the packer plate
 4. Carriage plate up button, moves the carriage plate up the slide track
- Control station only active when this side main control station is active
 - Functions only operate whilst your finger is held on the button
 - All operational tests self-explanatory

No:

SB197-20

Date:

11/03/20

Issue:

2

Subject:

Tailgate Control Box Checks and Breather Modification

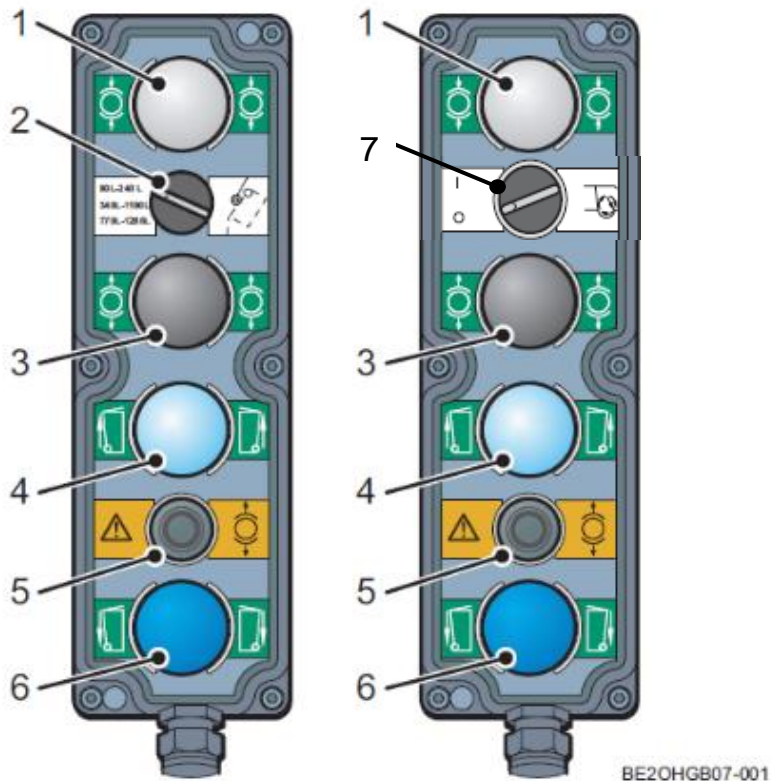
Beta control stations

1. Paladin clamp
 2. Catcher bar position switch
 3. Paladin un-clamp
 4. Bin lift raise
 5. Paladin unclamp override (used in conjunction with paladin unclamp if a bin slips through the arms and the lift cannot be lowered enough to release the bin).
 6. Bin lift lower
 7. Auto start switch for packer
- Control station only active when this side main control station is active
 - All operational tests self-explanatory

No:

SB197-20

Date:

11/03/20

Issue:

2

Subject:

Tailgate Control Box Checks and Breather Modification

Europa control stations

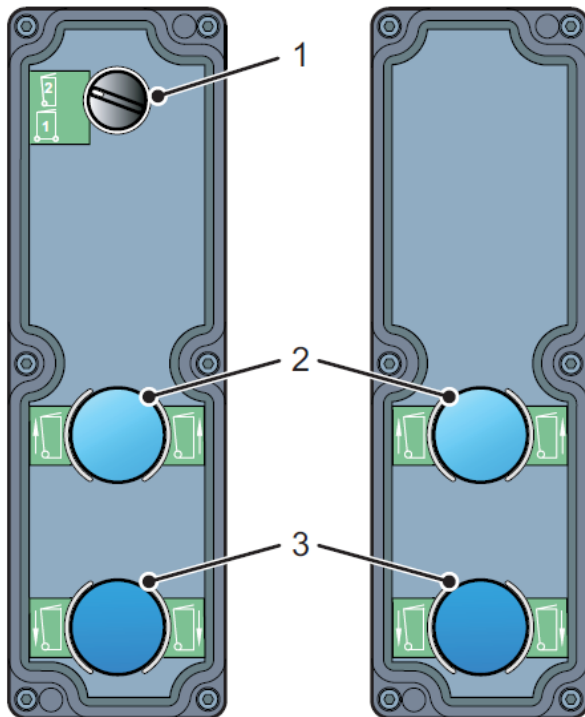

EU10HGB01-018

1. Two wheel or four-wheel container option, changes speed of lift and enables the auto gather function
 2. Bin lift raise
 3. Bin lift lower
- Control station only active when this side main control station is active
 - All operational tests self-explanatory

No:

SB197-20

Date:

11/03/20

Issue:

2

Subject:

Tailgate Control Box Checks and Breather Modification

Drain/breather modification

Water from high-pressure washers can enter through damaged boxes, buttons, seals, water may not be able to escape from the control station and may cause operational problems/breakdowns.

It is recommended a 4mm drain/breather hole is added to the lowest point of all control stations as shown in the illustrations below.

1. Apply insulation tape 5mm from the end of a 4mm drill bit.

2. Drill the control boxes as shown using a battery or pneumatic drill to a depth of 5mm indicated by the insulation tape. Clean burrs and hole to make sure it is clear

